

CITY OF SAN MATEO
RESOLUTION NO. ____ (2020)

**ACCEPTING THE SUMMARY VACATION OF AN EMERGENCY VEHICLE ACCESS EASEMENT
(BAY MEADOWS STATION BLOCK 1)**

WHEREAS, City Council approved the Bay Meadows Phase II Map No. 4 on January 7, 2013 and recorded on March 20, 2013 in Book 139 of Maps at Pages 11-24, at the San Mateo County Recorder's Office (Final Map); and

WHEREAS, Bay Meadows Track Investors, LLC dedicated an Emergency Vehicle Access Easement (EVAE) and Public Service Easement (PSE) for Block 14 (Station Block 1) to the City of San Mateo through the Final Map; and

WHEREAS, City Council approved the original commercial development for Station Block 1 (PA 07-054) on April 21, 2008 and Planning Commission approved a Planning Application Modification (PA 17-074) on September 25, 2018; and

WHEREAS, condition of approval #84 of PA 17-074 specifies vacation of the EVAE contingent on grant of an Alternate Means and Methods Request (AMMR) by the Fire Department, to build the project as approved;

WHEREAS, the Fire Department granted the AMMR for Station Block 1 and the PSE on Station Block 1 shall remain; and

WHEREAS, pursuant to the authority contained in the Streets and Highways Code Section 8333(c) of the State of California, the EVAE has been determined by the City to be excess because the granted AMMR provides the functional equivalent, and the PSE will remain for existing public facilities; and

WHEREAS, the Public Works Department and the City's contracted Licensed Surveyor found the legal description and plat of the EVAE vacation (Exhibits A & B attached) as technically correct.

NOW, THEREFORE, THE CITY COUNCIL OF THE CITY OF SAN MATEO, CALIFORNIA, HEREBY RESOLVES that:

1. The City Council finds and determines that the EVAE across Block 14 of Bay Meadows Phase II Map No. 4 approved by City Council on January 7, 2013, and recorded on March 20, 2013, in Books 139 of Maps, at Pages 11-24 at the San Mateo County Recorder's Office, is unnecessary for present or prospective emergency vehicle use.
2. The City Council hereby vacates the EVAE, pursuant to the authority of the Streets and Highway Code Section 8335.
3. The City Council hereby authorizes and directs the City Clerk to record a certified copy of this Resolution attested by the City Clerk under seal, with the San Mateo County recorder's office.

Exhibit 'A'

**Legal Description
Summary Easement Vacation
of
Emergency Vehicle Access Easement
APN 040-031- 250**

An easement over real property situated in the City of San Mateo, County of San Mateo, State of California being more particularly described as follows:

Being that Emergency Vehicle Access Easement as it encumbers Block 14 as shown in Detail "D" on Sheet 13 of that map entitled "Bay Meadows Phase II, No. 4" recorded on March 20, 2013 in Book 139 of Maps, at Pages 11-24, San Mateo County Records.

As shown on the plat attached hereto as "Exhibit B" and by this reference is made a part hereof.

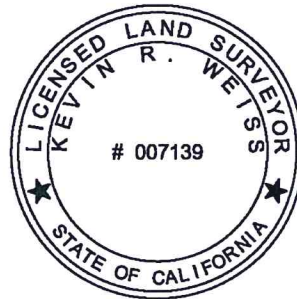

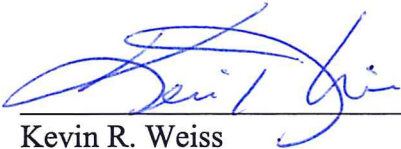
 06/18/20

Kevin R. Weiss Date

LEGEND & ABBREVIATIONS

- — — — — PROPERTY LINE - SUBJECT PARCEL
- — — — — PROPERTY LINE - ADJACENT PARCEL
- - - - - EASEMENT LINE
- E.V.A.E. EMERGENCY VEHICLE ACCESS EASEMENT

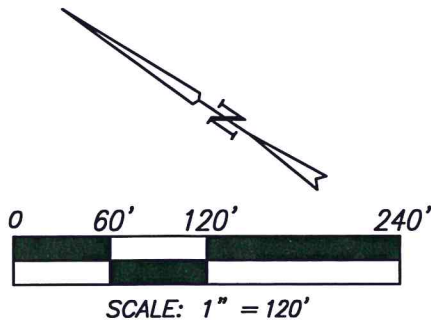
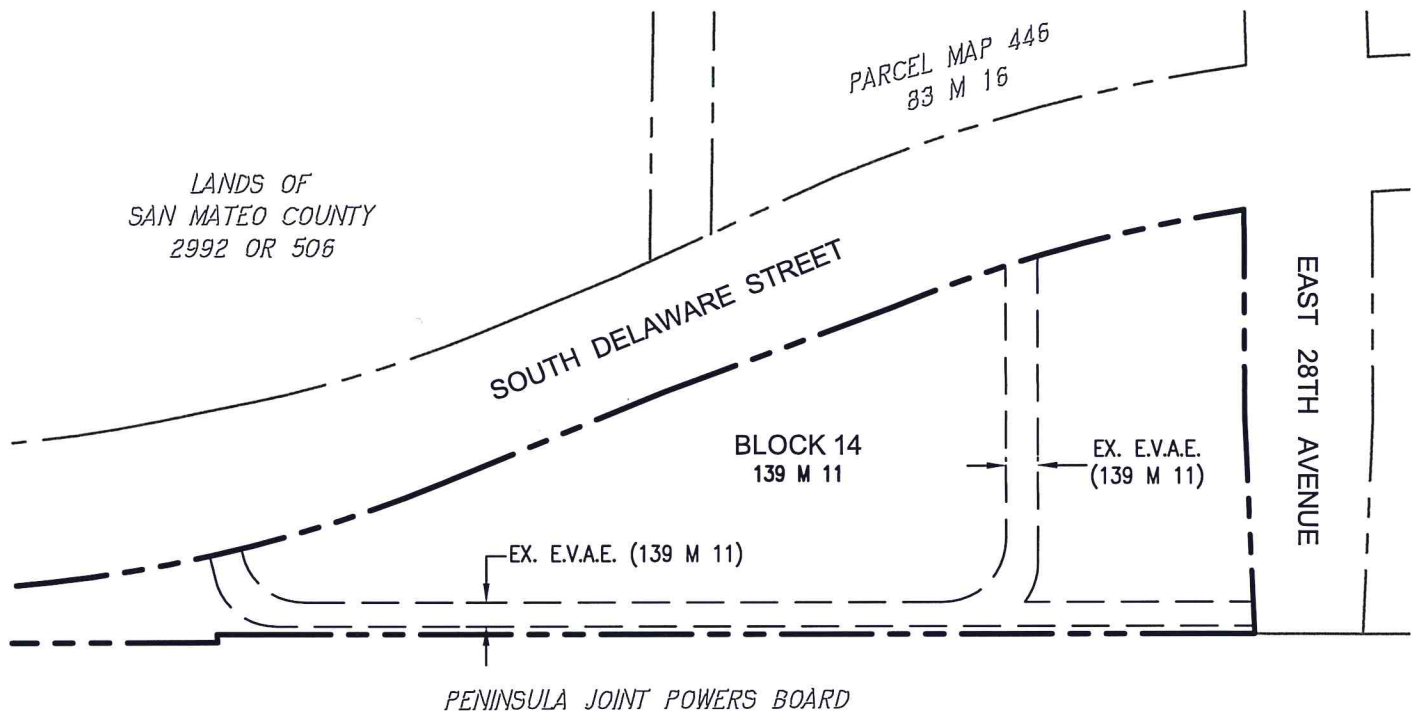

[Signature]
 KEVIN R. WEISS, L.S. 7139

06/18/20
 DATE

EXHIBIT 'B': PLAT TO ACCOMPANY LEGAL DESCRIPTION: SUMMARY VACATION
 EMERGENCY VEHICLE ACCESS EASEMENT

SCALE: AS SHOWN	DATE: 3/6/2020	BY: CT
SHEET 1 OF 1		JOB NO. 5070

JMH WEISS, INC.

1731 Technology Dr, Ste #880
 San Jose, CA 95110
 Phone: (408) 286-4555
 www.jmhweiss.com